



# HOTEL GRAND CHANCELLOR

CHRISTCHURCH



## Hotel Profile

The 4 star Hotel Grand Chancellor Christchurch is conveniently located in the heart of the CBD. Positioned adjacent to City Mall, it has Christchurch's best shopping, cafes, restaurants, entertainment and local attractions right on its doorstep.

The Hotel is one of the tallest buildings in Christchurch. With 26 floors, all rooms are quiet and spacious with sweeping views over the city and Canterbury plains to the distant snow capped Southern Alps.

## Rooms & Suites

Hotel Grand Chancellor Christchurch offers 176 well appointed accommodation rooms including 12 apartments. Accommodation begins on the 15th floor of the building, offering quiet, spacious rooms with stunning views.

All guest rooms are equipped with:

- > SKY TV
- > Pay per view movies
- > Broadband internet access
- > Iron / ironing board
- > Mini Bar
- > Tea & Coffee making facilities

## Restaurants & Bars

Open daily, Merchants Restaurant offers something for all tastes. Start your day with a-la-carte or full buffet breakfast. For dinner enjoy a range of starters, entrees and light meals. Our extensive selection of main courses are all made from fresh, local New Zealand produce.

After a hard day, there is no better place to unwind than The Exchange Bar, providing a relaxed and intimate setting with comfy leather chairs, just perfect for pre-dinner drinks or a coffee with friends.

## Facilities

- > 24 Hour Reception and Room Service
- > 24 Hour Car Parking and valet parking services\*
- > Concierge & Tour desk
- > Foreign Currency Exchange
- > Simply Coffee – take away coffee outlet
- > Safety Deposit Boxes
- > Dry Cleaning / Guest laundry facilities\*
- > Multi-lingual staff

*\*charges apply*

## Business & IT

- > Business Centre
- > Wireless internet access in all public areas\*
- > Broadband internet access in the business centre and all accommodation rooms\*
- > Computer access, printing, faxing, scanning and copying available\*
- > Secretarial services available\*

*\*charges apply*

# Hotel Grand Chancellor Christchurch

## Meetings & Events

Hotel Grand Chancellor Christchurch boasts the largest in-hotel conference facility in the South Island and can cater for up to 1000 delegates theatre style and 600 guests banquet style.

- > All eight conference rooms are located on level 14
  - > Plenary rooms, exhibition space, break out rooms and board rooms
  - > Adjustable room sizes with flexible layouts
  - > Dedicated catering facilities
- > Access for large equipment and vehicles
  - > Exhibition space for up to 65 trade booths
  - > Full audio visual and technical services available
  - > Experienced event management and operations team

## Function Facilities

Room	Metres	SqMetre	Height	Theatre	Classroom	Cocktail	Banquet	U Shape	Board	Trade Booths
Grand Chancellor Room (combined area Chancellors 1-4)		980	5.9 / 2.4	1000	500	1000	600	-	-	61 / 2.4m x 1.8m
Chancellor 1	24.5 x 12.5	300	5.9 / 2.57	300	160	300	180	70	68	30 / 2.4m x 1.8m
Chancellor 2	28.5 x 14.7	420	5.9 / 2.57	350	180	350	240	70	68	39 / 2.4m x 1.8m
Chancellor 3	14.8 x 7.5	110	2.88 / 2.4	80	36	80	50	32	28	10 / 2.4m x 1.8m
Chancellor 4	14.8 x 9.9	147	2.88 / 2.4	100	40	100	60	26	36	14 / 2.4m x 1.8m
Chancellor 5	21.5 x 9.5	240	5.9	200	100	200	120	50	52	12 / 2.4m x 1.8m
Christchurch Boardroom	6 x 7	42	2.88	30	16	30	20	14	16	-
Wellington Boardroom	6 x 7	42	2.88	30	16	30	20	14	16	-
Auckland Boardroom	8.5 x 4.5	38	2.88	25	12	25	20	-	18	-

## Floor Plans

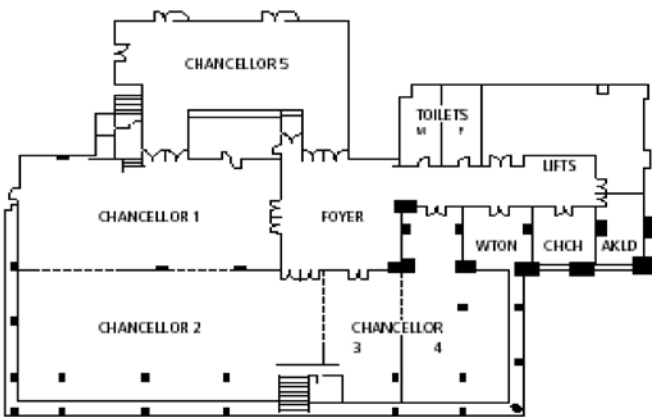

## Hotel Location



## Contact Details

### HOTEL GRAND CHANCELLOR CHRISTCHURCH

161 Cashel Street · Christchurch

P +64 3 379 2999 or 0800 275 337 (NZ) · 1800 753 379 (Aus)

F +64 3 379 0999 · E res@grandc.co.nz

A Member of Grand Hotels International  
Australia · New Zealand · Malaysia · Singapore · China

